

ALDEA

de Santa Fe

SANTA FE NEW MEXICO

AMENDED MASTER PLAN

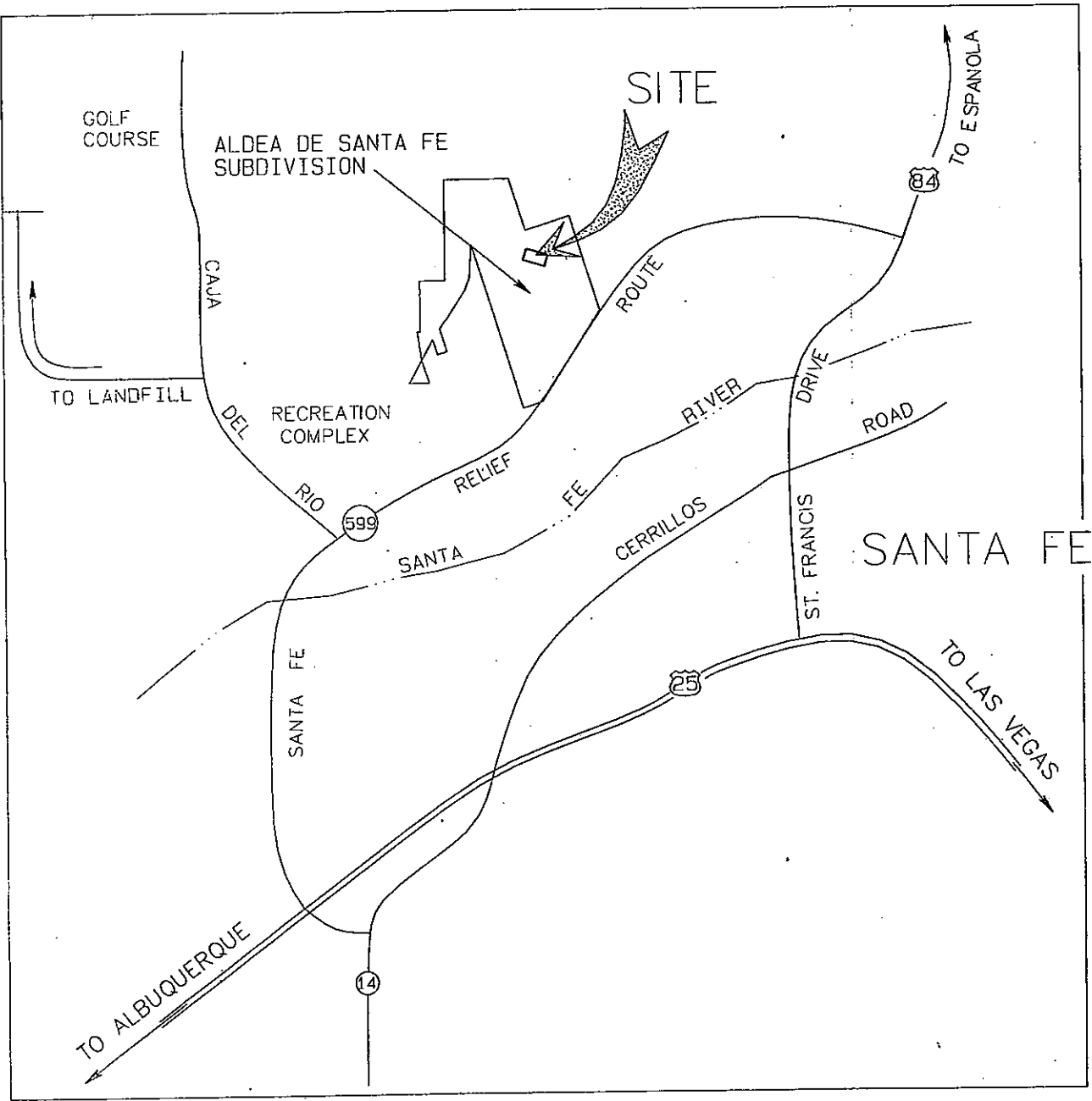

VICINITY MAP

NOT TO SCALE

INDEX:

- MP-0 COVER
- MP-1 AMENDED MASTER PLAT
- MP-2 PARTIAL MASTER PLAN
- L-1 PARTIAL LANDSCAPE PLAN
- GD-1 PARTIAL GRADING / DRAINAGE PLAN
- MP-3 CONCEPTUAL MASTER UTILITY PLAN

PURPOSE STATEMENT: THE PURPOSE OF THIS MASTER PLAN AMENDMENT IS TO ALLOW UP TO 185,000 SQ. FT. OF COMMERCIAL DEVELOPMENT TO ADD TIMESHARE UNITS TO THE LIST OF ALLOWED USES, AND FOR APPROVAL TO DEVELOP THE PROPOSED LODGE IN THREE PHASES.

MASTER PLAN AMENDMENT FOR ALDEA DE SANTA FE
T-17N, R-9E, Section - 20, Santa Fe County, New Mexico

Affidavit
Know all persons by these present that the undersigned owners has caused this Master Plan to be prepared. All that appears on this plan is made with the free consent and in accordance with the desires of the undersigned owners. This development lies within the planning and platting jurisdiction of the City and County of Santa Fe, New Mexico.

Owner, Aldea LLC, By Arthur Fields, Authorized Agent

Arthur Fields

The foregoing was sworn, acknowledged and subscribed before me by 25 this APRIL day of 2005
Notary Public Steven P. Febringer
My Commission Expires on 09-17-07



COUNTY AND CITY APPROVALS

Approved by the Extrajurisdictional Zoning Authority at their meeting of February 23, 2005

Michael Keenan 2/22/05
Chairman Date

Approved by the Extrajurisdictional Zoning Commission at their meeting of February 24, 2005

Nancy A. Long 2/14/05
Chairman Date

County Development Permit No. 4395

Approved by Vicki Secora 7/27/05
County Land Use Administrator Date

Approved by B. H. Hoff 4-26-05
County Fire Marshal Date

Approved by John V. Vito 5-3-05
County Public Works Director Date

Approved by MSullivan 04-19-05
City Subdivision Engineer Date

Approved by Harriet 4-19-05
City Planner Date



1391004
COUNTY OF SANTA FE
STATE OF NEW MEXICO
I HEREBY CERTIFY THAT THIS INSTRUMENT HAS BEEN FILED FOR RECORD ON THE 25th DAY OF APRIL, A.D. 2005 AT 11:40 A.M. IN BOOK 27-1-596 AND WAS FILED IN BOOK 27-1-596 IN THE RECORDS OF SANTA FE COUNTY, NEW MEXICO.
Witness my Hand and Seal of Office at Santa Fe, New Mexico, this 25th day of April, 2005.
Phyllis M. Baskin
County Clerk

LORN TRYK ARCHITECTS
206 McKenzie, Suite F2
Santa Fe, New Mexico 87501
Telephone: 505-982-5340 Fax: 505-982-5393
E-Mail: mail@ltryk.com

ALDEA de Santa Fe
SANTA FE NEW MEXICO
REVISED MASTER PLAN

Date	Apr 18, 05
Revised	
Drawn by	
Checked by	27
Job Number	0218
Sheet Title	Cover
Sheet No.	MP-0

PERMITTED USES:

COMMERCIAL LOTS:

- RETAIL ESTABLISHMENTS
- RESTAURANTS AND BARS
- PERSONAL SERVICE ESTABLISHMENTS
- OFFICE AND STUDIOS, MEDICAL OFFICES AND/OR CLINICS
- BANKS OR OTHER FINANCIAL INSTITUTIONS
- CHURCHES OR OTHER RELIGIOUS INSTITUTIONS
- LIQUOR AND PACKAGE STORES
- MINI-STORAGE UNITS
- GALLERIES
- PRIVATE CLUBS AND LODGES
- VETERINARY ESTABLISHMENTS
- COMMERCIAL INDOOR RECREATION
- BED AND BREAKFAST INNS / HOTELS
- OUTDOOR MARKETS
- TIME SHARE UNITS
- LIVE/WORK UNITS

INSTITUTIONAL LOTS:

- EDUCATIONAL INSTITUTIONS AND CIVIC AND RELIGIOUS ORGANIZATIONS, INCLUDING MUSEUMS, SCHOOL BUILDINGS, SCHOOL CAMPUSES, CHURCHES, RETIREMENT HOUSING, BOTANICAL GARDENS, AND ACCESSORY USES AND STRUCTURES.

OPEN SPACE:

OPEN SPACE MAY BE USED FOR RECREATIONAL USES AND ACTIVITIES INCLUDING, BUT NOT LIMITED TO, TRAILS, HORSE STABLES, BALL FIELDS, AND BOTANICAL GARDENS. THE USE OF COMMON AREAS WITHIN THE DEVELOPED AREA, SUCH AS PLAZAS, PARKS, AND TRAIL CONNECTIONS TO LARGER OPEN AREAS IS ENCOURAGED AND WILL COUNT TOWARDS THE 205 ACRE OPEN SPACE REQUIREMENT. EXCEPT FOR PARKING LOTS, THE OPEN SPACE PROVIDED AROUND INSTITUTIONAL BUILDINGS CAN BE USED TOWARDS THE 205 ACRE OPEN SPACE REQUIREMENT. PROVIDED HOWEVER, THE 29 ACRE PARCEL IDENTIFIED AS TRACT G, ADJACENT TO LAS CAMPANAS ESTATES II SHALL NOT BE USED FOR HORSE STABLES OR BALL FIELDS.

NOTES:

- ① MPT = MASTER PLAT TRACT
- ② OPEN SPACE SHALL REMAIN NO LESS THAN 205 ACRES

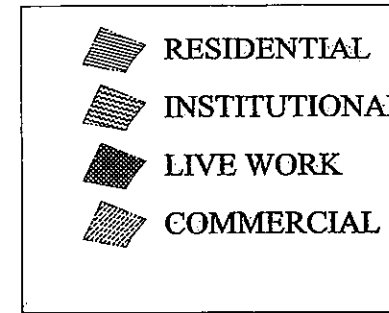

Total Developable Lots - Residential and Live/Work			
594 050			
	Affordable	Market Rate	Total
Phase 1A	10	104	114
* 6 Density Units moved to future phases; Lots 121,122,123,134,135 and 129			
Phase 1B	15	84	99
* 1 Density Unit moved to future phases; Lots 188			
Phase 2A	2	46	48
* 2 Density Units moved to future phases; Lots 268 and 269			
Phase 2B	3	49	52
Phase 2C	12	57	69
Phase 2D	1	59	60
Live/Work Units	0	32	32
Hold 2 Density Units (not used)	0	2	2
Totals			
Hold 2 Density Units	0	2	2
Totals	43	433	476
Commercial and Institutional		185,000 s.f.	
Commercial		185,000 s.f.	
Institutional Lots		10.0 ac.	

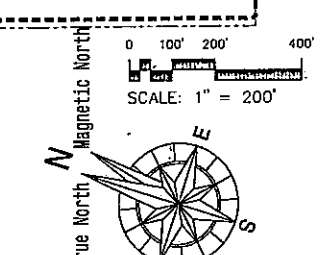
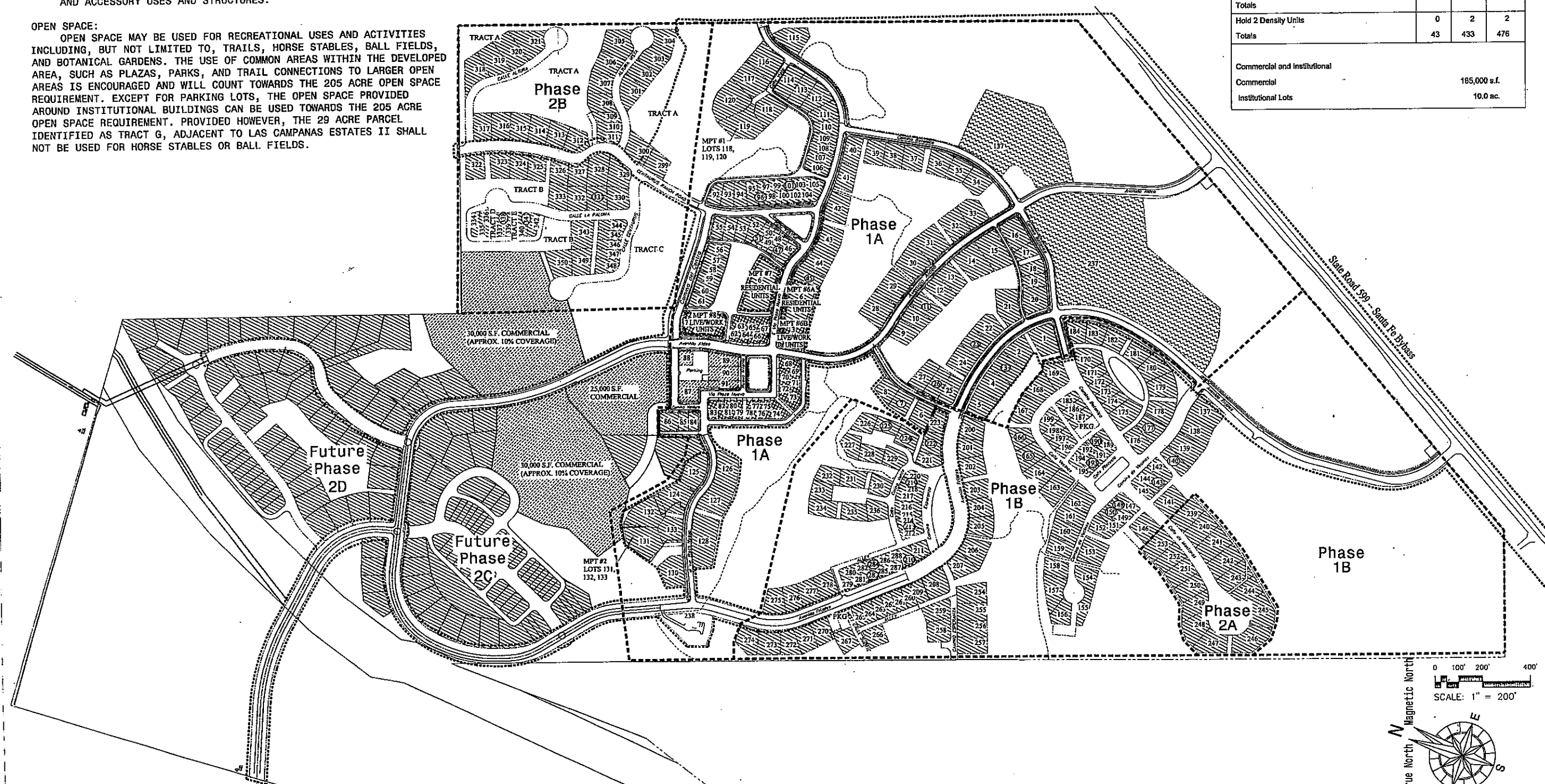

LORN TRYK ARCHITECTS
 206 McKenzie, Suite F2
 Santa Fe, New Mexico 87501
 Telephone: 505-982-5340 Fax: 505-982-5393
 E-Mail: mail@ltryk.com

ALDEA
 de Santa Fe
 SANTA FE NEW MEXICO
REVISED MASTER PLAN

Date: Apr 26, 05
 Revised:
 Drawn by:
 Credited by:
 Job Number: 0218
 Sheet Title: Amended Master Plan
 Scale: 1" = 200'-0"
 Sheet No.: **MP-1**

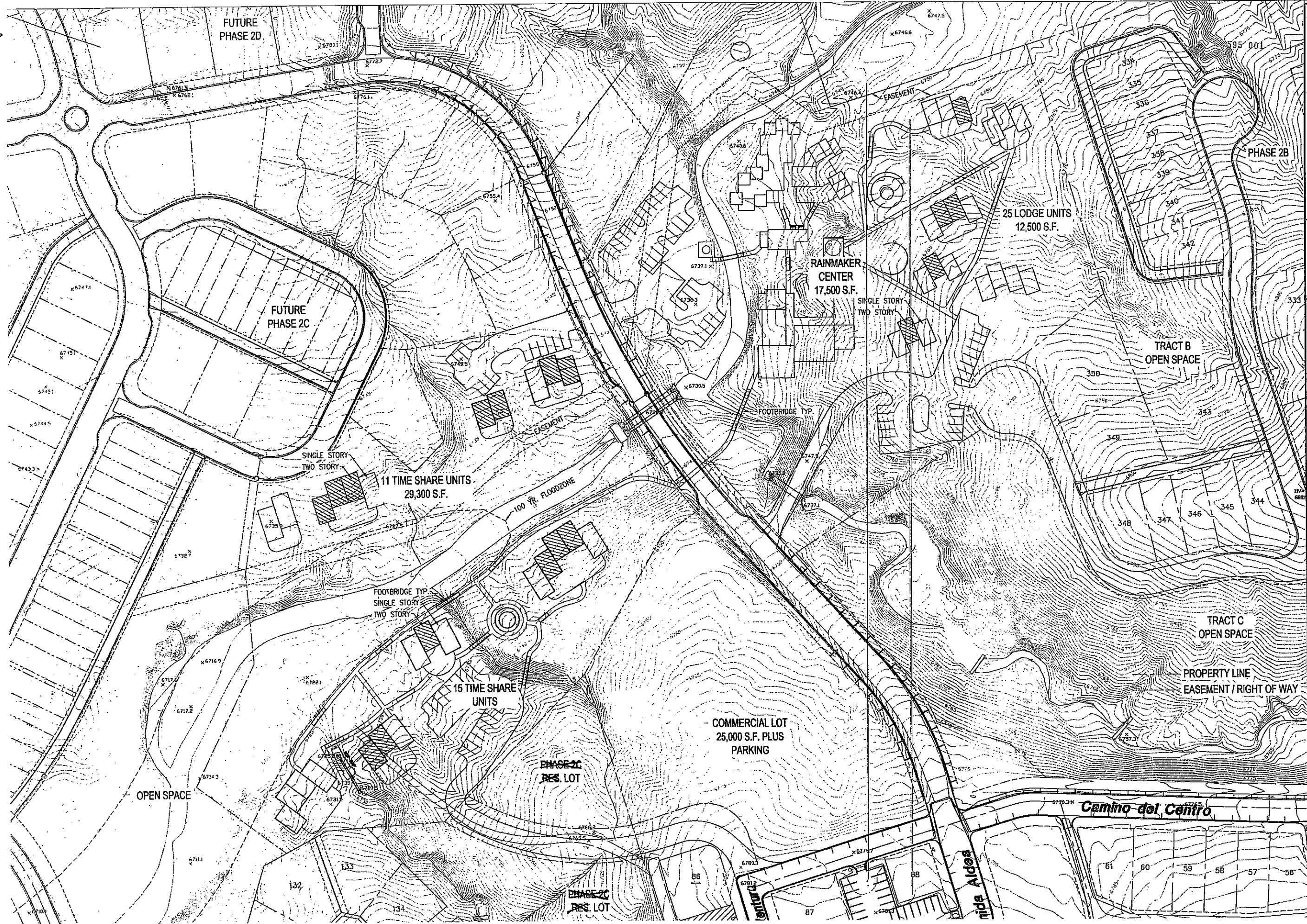

LORN TRYK ARCHITECTS
 206 McKenzie, Suite P2
 Santa Fe, New Mexico 87501
 Telephone: 505-982-5340 Fax: 505-982-5393
 E-Mail: mail@ltryk.com

ALDEA
 de Santa Fe NEW MEXICO
 SANTA FE REVISED MASTER PLAN

Date Apr 18, 05

Revised

Drawn by
 Checked by 2.2
 Job Number

Sheet Title
 PARTIAL
 MASTER
 PLAN

SCALE: 1:50
 Sheet No.

MP-2